

\*FOR REFERENCE ONLY\*

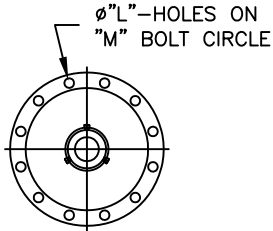

SECTION "B-B"

MOUNTING FLANGE ORIENTATION

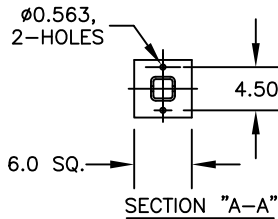

SECTION "A-A"

NOTES:

1. ALL DIMENSIONS ARE IN INCHES.
2. WEIGHT INCLUDES TYPICAL TEFC MOTOR. MOTOR WEIGHTS VARY BY MANUFACTURER AND ENCLOSURE.
3. LARGER FLANGE SIZES ARE OPTIONALLY AVAILABLE.
4. IN-TANK SHUTOFF IS OPTIONALLY AVAILABLE FOR EITHER MECHANICAL SEAL OR STUFFING BOX.

UNIT SIZE	OUTPUT RPM	HP	MOTOR FRAME	WEIGHT (LBS.)	A	B	C	D	E	F	G	H	J	K	ANSI FLANGE SIZE	L	M
1	420	1	143T	690	23.0	10.0	20.0	32.5	22.0	4.0	2.00	23.8	14.0	17.8 TO 27.8	8"-150# 8 HOLES STRADDLE CENTERLINE	.875	11.75
		2	145T	700													
		3	182T	730													
		5	184T	750													
		7.5	213T	820													
	280	10	215T	840	25.0												
		15	254T	905	26.0												
		1	145T	690	23.0												
		2	184T	735	24.0												
		3	213T	810	25.0												
2	420	5	215T	825	25.0	14.0	28.0	35.5	24.0	4.6	2.50	24.5	20.0 TO 30.0	10"-150# 12 HOLES STRADDLE CENTERLINE	1.0	14.25	
		7.5	254T	895													
		10	256T	920													
		15	254T	1220													
		20	256T	1245													
	280	25	284T	1360	40.5												
		30	286T	1385	40.5												
		10	256T	1240	39.3												
		15	284T	1350	40.5												
		20	286T	1380	40.5												
3	420	25	324T	1520	41.4	16.0	32.0	43.5	26.0	5.2	3.00	29.0	23.3 TO 33.3	12"-150# 12 HOLES STRADDLE CENTERLINE	1.0	17.00	
		30	286T	2030													
		40	324T	2170													
		50	326T	2345													
		60	364T	2740													
	280	25	324T	2160	51.5												
		30	326T	2185	50.5												
		40	364T	2665	51.5												
		50	365T	2800	55.5												
		20.0	40.0														

\* ALL DIMENSIONS AND WEIGHTS ARE FOR REFERENCE ONLY UNLESS THE DRAWING IS CERTIFIED.  
 \* ALL EQUIPMENT DESIGN AND APPLICATION DATA SHOWN HEREIN IS CONFIDENTIAL AND THE PROPERTY OF BRAUN MIXER. NO USE OR DISCLOSURE THEREOF MAY BE MADE WITHOUT OUR WRITTEN PERMISSION.



12838 STAINLESS DRIVE  
 HOLLAND, MI. 49424  
 PH. 616-399-5600  
 FAX 616-399-3084

MIXER MODEL  
**BVSE SIDE ENTRY MIXER**  
 V BELT DRIVE  
 WITH STUFFING BOX OR MECHANICAL SEAL  
 DIMENSION AND ASSEMBLY DRAWING

DRAWN BY: GMc      DATE: 5-28-99      © 2018  
 APPROVED BY:      DATE:

DWG. NO. **A- TK0098**      REV.