

NOTES:

1. BASIC WEIGHT DOES NOT INCLUDE SHAFT, IMPELLER(S) OR MOTOR.
2. ALL DIMENSIONS ARE IN INCHES AND ARE FOR REFERENCE ONLY UNLESS CERTIFIED.
3. FLANGE MOUNTED UNITS ALSO AVAILABLE. CONSULT FACTORY FOR APPLICABLE DIMENSIONS.
4. AF3 HYDROFOIL TURBINE IMPELLERS SHOWN. OTHER IMPELLERS AVAILABLE UPON REQUEST OR PER APPLICATION.

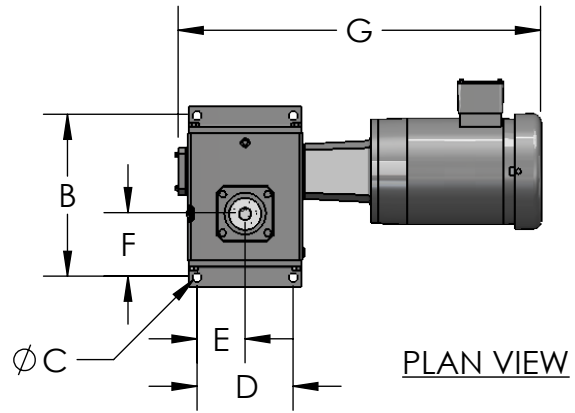

NEMA C-FACE MOTOR

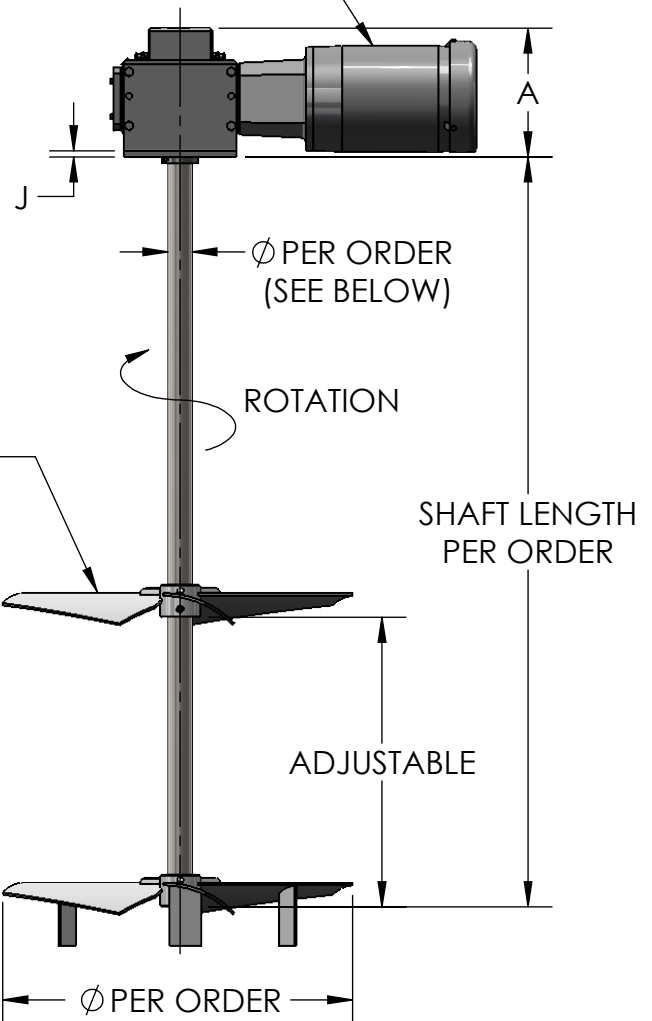

FOR REFERENCE ONLY



OPTIONAL "PICKET FENCE" IMPELLER

CASE SIZE	BWG DIMENSIONS									BASIC ① WGT. (LBS)	STD. SHAFT DIAM.
	A	B	ØC	D	E	F	G	H	J		
11	7.0	7.38	0.44	4.00	2.00	2.88	20.0	10.0	0.25	30	1.25
12	8.2	10.13	0.56	5.75	2.88	4.00	22.8	12.2	0.38	75	1.50
13	10.0	11.88	0.56	6.12	3.06	4.75	24.3	13.6	0.38	100	2.00
14	13.5	14.88	0.69	7.88	3.94	6.19	27.0	17.3	0.50	180	2.50
15	14.5	18.00	0.78	10.00	5.00	7.12	30.9	20.8	0.50	290	3.00

* ALL DIMENSIONS AND WEIGHTS ARE FOR REFERENCE ONLY UNLESS THE DRAWING IS CERTIFIED.

* ALL EQUIPMENT DESIGN AND APPLICATION DATA SHOWN HEREIN IS CONFIDENTIAL AND THE PROPERTY OF BRAWN MIXER. NO USE OR DISCLOSURE THEREOF MAY BE MADE WITHOUT OUR WRITTEN PERMISSION.



12838 Stainless Drive
Holland, MI 49424

PH: 616-399-5600
FAX: 616-399-3084

MIXER MODEL
BWG PLATE

OPEN TANK MOUNTED MIXER
DIMENSION AND ASSEMBLY DRAWING

DRAWN BY: BSB DATE: 10/9/2018 © 2018

APPROVED BY: DATE:

DWG. NO. **A- TK0038** REV.